

01|Product Charging / Discharging Guide

Unscrew the button cover, USB data line access
Micro USB charging / discharging port.

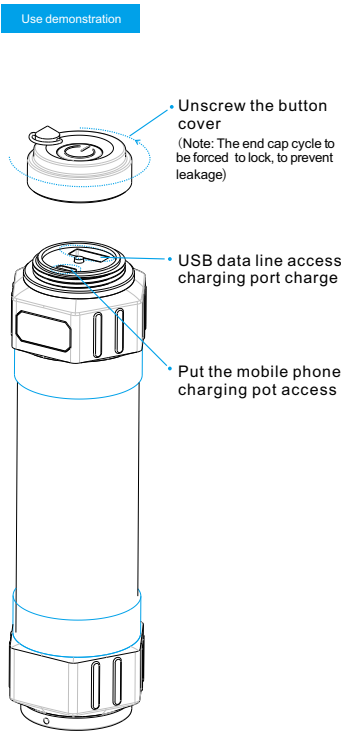

02|Product Function characteristic

- 1、USB data line charging, can be connected to the charger, Charging treasure or computer USB interface can charge, Full of electricity can be used for more than 4hours,the data line can also give the phone charging.
- 2、Can be used as mobile phone, charging for mobile phone.
- 3、With warning flash, real-time lighting bright ,low light, flash and SOS signal for help 6 ways of use,1 swithes,6 modes of free switching, often by close.
- 4、Waterproof, waterproof performance of up to IP68.
- 5、The design of magnet and lanyard,on the back, increasing the adsorption function convenient suspension; with a wall mounted portable hanging type, etc...
- 6、There are strong flashlight function, can be irradiated in the long distance.
- 7、The product can suck, couple lights, meaning extraordinary.
- 8、Electric quantity display indicator light function.

- 30 hours of working hours
- Waterproof IP68
- Mobile phone charging function
- Magnetic adsorption function

03|Product Component Material

- ABS plug/ABS resin is the five major synthetic is one of the resins , the impact resistance, Heat resistance, low temperature resistance, resistance of chemical and electrical properties Excellent good surface gloss.
- Silicone decorative ring/Silica gel has excellent heat resistance, Cold resistance, dielectric properties.
- PC transparent/Original meters, will not aging, high permeability light, high strength, resistance to fall, etc. Features ,easy to protect the light source.
- Strong magnet/Neodymium iron boron permanent magnet, small in size and light in weight, magnetic characteristics, light loose free adsorption, clever design ,hands free.

Note: This product contains a magnet , do not use the same medical or electronic equipment together, so as to avoid the possible set of damage caused.

04|Product Life Time

Art NO	Battery Capacity	High light	Soft light	Moderate light	Mosquito lighting	Red/Blue alternately	Flash light	Maximum rated power	Electrical parameters	Luminous flux	Remarks
N95	2600mAh	8H	30H	20H	20H	30H	20H	3W	In:5V Out:5V 1A	160lm	Routine

05|Product Control Function Mode

Function description
Short press the switch mode, long press off, IC into sleep.

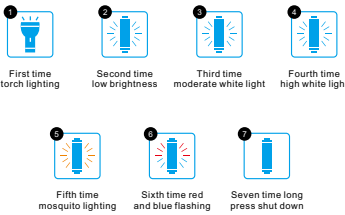

06|Product Application Scenarios

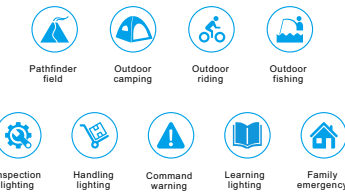

07|Product Accessories Description

- Essential goods
- USB data line one
 - Screw hanging ring one
 - Lanyard one

Outdoor waterproof LED lamp

- Power bank
- lighting
- Emergency lamp
- mosquito repellent Lamp
- Flashlight
- broken windows

01 | 产品充 / 放电指南

旋开按钮端盖，将USB数据线接入MICRO USB充/放电口。

使用示范

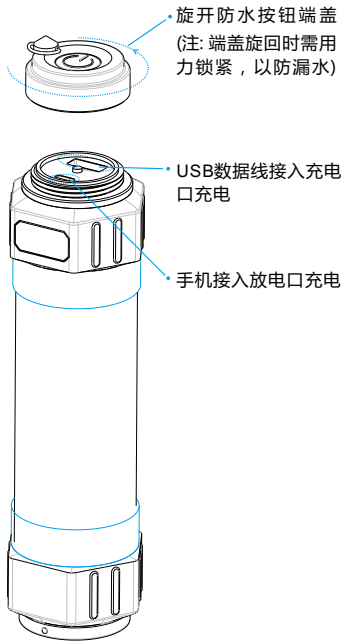

02 | 产品功能特性

- 1、USB数据线充电式，可接充电器、充电宝或电脑USB 接口都能充电，充满电可连续使用4小时以上，赠送的数据线也可以给手机充电。
- 2、可以当移动宝使用，对手机进行充电。
- 3、具有警示闪光、实时照明高亮、柔亮、闪光及SOS呼救信号6种使用方式，1个开关，6种模式自由切换，长按关闭。
- 4、可防水，防水性能达IP68。
- 5、背面上磁铁及挂绳设计，增加吸附功能，方便悬挂；具有壁挂式、手提式、吊式等。
- 6、有强光手电筒功能，可照射长远距离。
- 7、产品可对吸，情侣灯，意义非凡。
- 8、电量显示指示功能。

- 30小时工作时间
- 防水性能 IP68
- 手机充电功能
- 磁性吸附功能

04 | 产品续航时间

产品型号	容量	柔亮	中亮	高亮	爆闪红蓝	驱蚊照明	手电筒	最大功率	电参数	光通量	备注
N95	2600mAh	30H	20H	8H	30H	20H	20H	3W	In:5V Out:5V 1A	160lm	常规

05 | 产品控制功能模式

功能说明
短按切换模式，长按关机，IC进入睡眠。

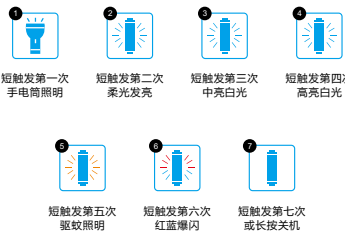

06 | 产品应用场景



07 | 产品配件说明

- 必备品
- USB数据线 1件
 - 螺丝挂环 1件
 - 挂绳 1件

03 | 产品部件材质

- ABS堵头/ABS树脂是五大合成树脂之一，抗冲击性、耐热性、耐低温性、耐化学药品性及电气性能优良，表面光泽性好。
- 硅胶装饰圈/硅胶具有优异的耐热性、耐寒性、介电性等性能。
- PC透明管/原米，不会老化，高透光，高强度，耐抗摔等特点，轻松保护光源。
- 强力磁铁/钕铁硼永久性磁铁，体积小、重量轻、磁性强的特点，轻松自由吸附，巧妙设计，解放双手。

注: 本产品内含磁铁，请勿将其同医疗或电子设备放在一起，以免可能对设备造成损害。

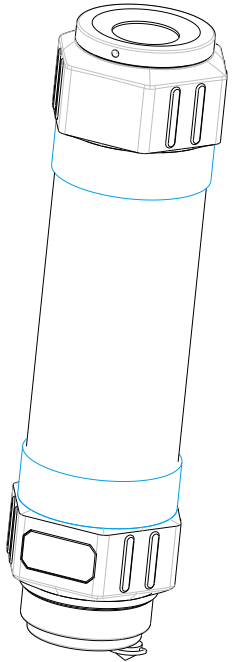

户外防水LED灯

- 充电宝
- 应急灯
- 照明灯
- 手电筒
- 驱蚊灯
- 破窗